

### MATERIAL OPTIONS

CLASS 1 COPPER/ZIRCONIUM C15000  
 CLASS 2 COPPER/CHROMIUM C18200  
 CLASS 2 COPPER/CHROMIUM/ZIRCONIUM C18150  
 CLASS 3 COPPER/NICKEL/BERYLIUM C17510  
 REFRACTORY METALS AVAILABLE UPON REQUEST

### WHEEL DIMENSIONS

WT: \_\_\_\_\_  
 R: \_\_\_\_\_  
 D1: \_\_\_\_\_  
 D2: \_\_\_\_\_  
 D3: \_\_\_\_\_  
 F: \_\_\_\_\_  
 W: \_\_\_\_\_  
 X: \_\_\_\_\_  
 P: \_\_\_\_\_  
 PD: \_\_\_\_\_  
 BC: \_\_\_\_\_  
 N: \_\_\_\_\_  
 T: \_\_\_\_\_  
 MAT'L: \_\_\_\_\_

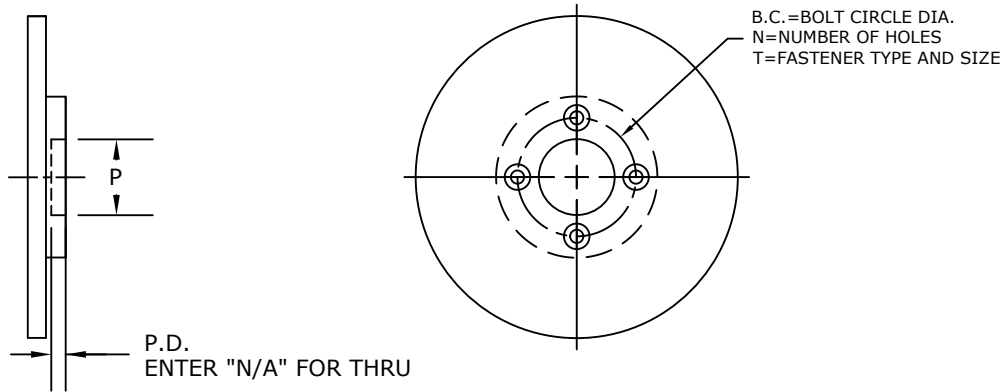

### NOTES: